

Ballistic Resistant Solutions

General Application

The Southern States **Ballisti-Wall**[®] and **Ballisti-Cover**[®] ballistic resistant solutions offer military grade protection for utility critical infrastructure facilities and equipment. Originally developed for use by the Department of Defense for protection from mortar fire, these products offer superior ballistic resistance and a significant weight advantage over commonly used products.

Ballisti-Wall and Ballisti-Cover are constructed from multiple layers of woven fiberglass encapsulated with a proprietary resin system that produces a rigid panel with exceptional ballistic resistance. The unique composite matrix of the panels allow for retention of the projectile to avoid potentially hazardous ricochet. These protection products offer ballistic resistant security with the additional performance advantages of durability, corrosion resistance, electrical non-conductivity, low thermal conductivity and light weight.

Surface finish is smooth in a white color (which can be painted) with custom colors available in production quantities. Ballisti-Wall and Ballisti-Cover utilize standard panel sizes which are available with a nominal thickness of 1/4", 3/8" and 1/2" for protection to UL 752 levels 1 thru 8 and NIJ Levels I, II & IIIA test standards. Additional levels of protection can be provided by layering these standard panels.

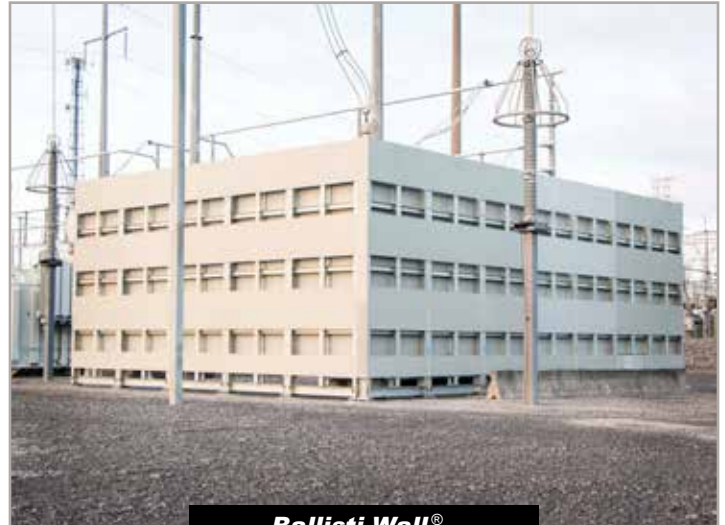

Ballisti-Wall[®]



Ballisti-Cover[®]

Physically Securing Substations and Critical Assets

CONSTRUCTION

The **Ballisti-Wall**® is typically designed in vertical sections allowing for easy installation and removal if required. Sectional details consist of ballistic panels between steel or fiberglass wide flange beams. Panels are overlapped to ensure total protection and can be positioned to allow air flow. The design also features the ability to replace individual panels without having to remove or replace a wall section should the need arise

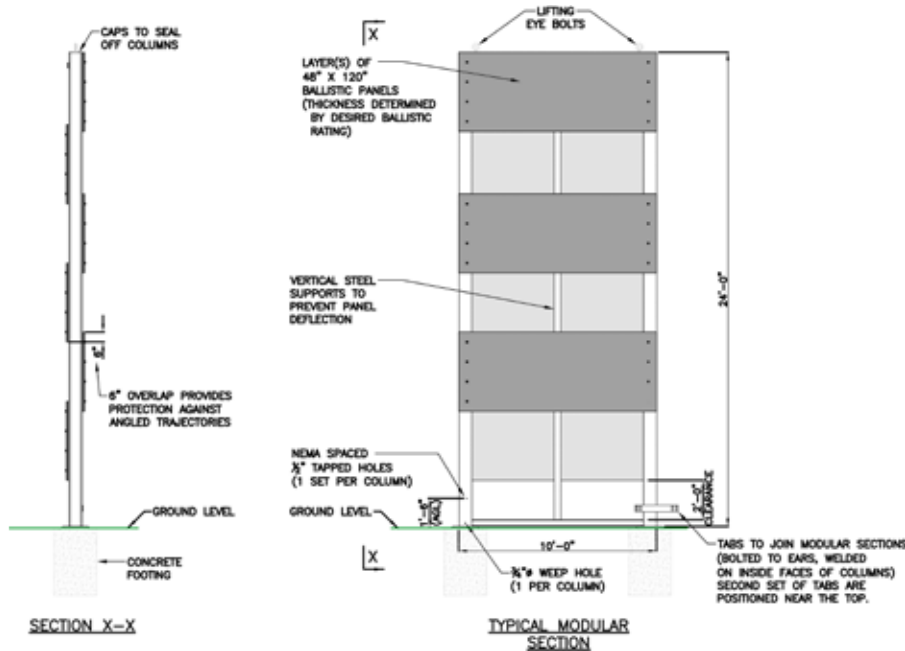

TABLE OF UL STANDARD 752 PERFORMANCE STANDARDS LEVEL RATING CHART

UL-752 Rating	UL-752 Ammunition Specifications				Number of Shots	Ballistipanel Standard			
	Ammunition	Grain	(g)	Minimum Velocity		Ballistipanel Qty. Level Tested	Total Thickness	Weight lbs/psf	
				fps					(m/s)
Level 1	9 mm full metal copper jacket with lead core	124	8.0	1,175	358	3	1 panel of Level 1	0.25"	2.7
Level 2	.357 magnum jacketed lead soft point	158	10.2	1,250	381	3	1 panel of Level 2	0.375"	4.0
Level 3	.44 magnum lead semi-wadcutter gas checked	240	15.6	1,350	411	3	1 panel of Level 3	0.5"	5.4
Level 4	.30 caliber rifle lead core soft point	180	11.7	2,540	774	1	3 panels of Level 3	1.5"	16.2
Level 5	7.62 mm rifle lead core full metal copper jacket ,military ball	150	9.7	2,750	838	1	3 panels of Level 3	1.5"	16.2
Level 6	9 mm full metal copper jacket with lead core	124	8.0	1,400	427	5	1 panel of Level 2	0.375"	4.0
Level 7	5.56 mm rifle full metal copper jacket with lead core	55	3.56	3,080	939	5	3 panels of Level 3	1.5"	16.2
Level 8	7.62 mm rifle lead core full metal copper jacket, military ball	150	9.7	2,750	838	5	3 panels of Level 3	1.5"	16.2

PANEL AVAILABILITY SIZE

Panel Thickness	Panel Size	Nominal Weight (lbs)
.256" (1/4")	36" x 84"	57
	36" x 96"	65
	36" x 108"	73
	36" x 120"	81
	48" x 96"	85
	48" x 108"	97
	48" x 120"	108

.384" (3/8")	36" x 84"	84
	36" x 96"	96
	36" x 108"	108
	36" x 120"	120
	48" x 96"	128
	48" x 108"	144
	48" x 120"	160

.512" (1/2")	36" x 96"	130
	36" x 108"	146
	36" x 120"	165
	48" x 96"	173
	48" x 108"	194
	48" x 120"	216

ADVANTAGES

- ▶ Electrically non-conductive
- ▶ Thermally non-conductive
- ▶ Electromagnetically transparent
- ▶ Ease of installation
- ▶ Corrosion resistant
- ▶ Durability
- ▶ Paintable
- ▶ Non-ricochet, retains projectile
- ▶ Custom colors available
- ▶ Lightweight. Approximately 25% the weight of steel

APPLICATIONS

- ▶ Critical asset protection including:
 - Motor operator protection
 - Communications box
 - Safe room
 - Shelter
 - Control house interior panels
 - Battery cabinet protection
 - Power transformers
 - Turn Key applications available

INSTALLATION

- ▶ Turn Key Services

